

ABL Anchor Bolt Locator

The ABL enables the accurate and secure placement of anchor bolts on concrete-deck forms prior to concrete placement. The structural heavy-hex nut is attached to a pre-formed steel "chair," which eliminates the need for an additional nut on the bottom of the anchor bolt. Electrogalvanized versions available for HDG anchor bolts. Order ABL-OST when using HDG anchor bolts.

Features:

- Designed for optimum concrete flow
- Installed with two nails or two screws
- Meets code requirement for 1" standoff
- The ABL is designed for use with SAR anchors

Material: Nut — Heavy hex; Chair — 14 gauge

Finish: Nut — None or Electro-galvanized;
Chair — G90

Codes: See p. 13 for Code Reference Key Chart

Please visit **strongtie.com**
for ABL load ratings.

| Model No. | Anchor Bolt Diameter (in.) | Code Ref. |
|-----------|----------------------------|-----------|
| ABL4-1 | 1/2 | — |
| ABL5-1 | 5/8 | |
| ABL6-1 | 3/4 | |
| ABL7-1 | 7/8 | |
| ABL8-1 | 1 | |
| ABL9-1 | 1 1/8 | |
| ABL10-1 | 1 1/4 | |

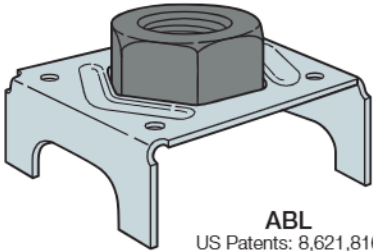

ABL
US Patents: 8,621,816
and 8,381,482

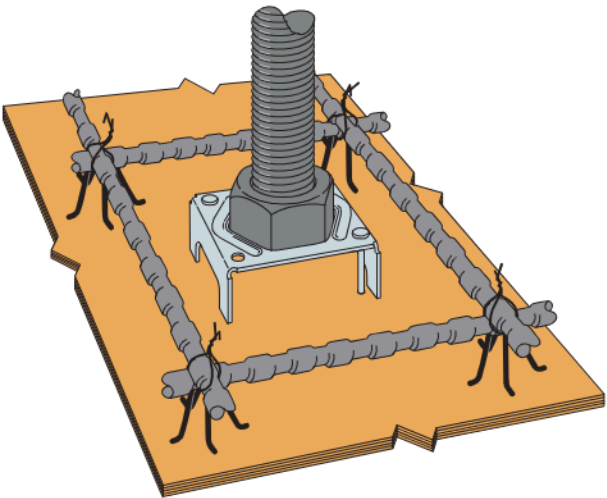

Typical ABL Installation

SAR

Shallow Anchor Rod

SAR anchor rods are for use with the ABL anchor bolt locator. They combine to make an economical podium-deck anchorage solution. Anchorage specification is per designer.

Features:

- Proprietary, preattached plate washer
- Available in standard or high strength
- Anchor rod diameters from ½" to 1 ¼"
- Standard lengths available 18", 24", 30" or 36"
- Specify "HDG" for hot-dip galvanized

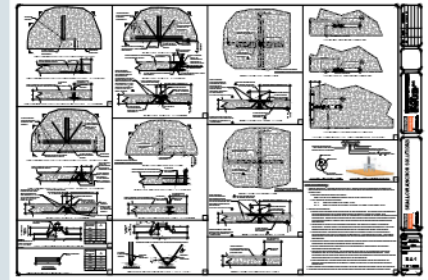
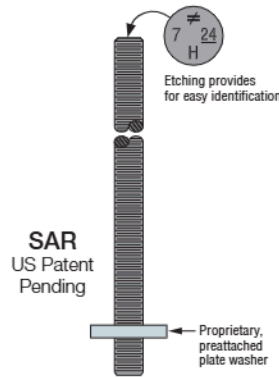

Reference the Shallow Anchor Solutions details for more information.

Visit strongtie.com/sardetails.

ABL

Anchor Bolt Locator

The ABL enables the accurate and secure placement of anchor bolts on concrete-deck forms prior to concrete placement. The structural heavy-hex nut is attached to a preformed steel "chair," which eliminates the need for an additional nut on the bottom of the anchor bolt. Electrogalvanized versions available for HDG anchor bolts. Order ABL-OST when using HDG anchor bolts.

Features:

- Designed for optimum concrete flow.
- Installed with (2) nails or (2) screws.
- Meets code requirement for 1" stand off.
- The ABL is designed for use with SAR anchors.

Material: Chair — 14 gauge

Finish: Nut — none or electrogalvanized; chair — G90

| Model No. | Anchor Bolt Diameter (in.) |
|-----------|----------------------------|
| ABL4-1 | ½ |
| ABL5-1 | ⅝ |
| ABL6-1 | ¾ |
| ABL7-1 | 7/8 |
| ABL8-1 | 1 |
| ABL9-1 | 1 ⅛ |
| ABL10-1 | 1 ¼ |

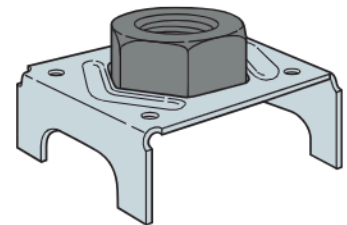

ABL
US Patents 8,621,816
and 8,381,482

Shallow Podium Slab

Anchor Kit

The Shallow Podium Slab anchor kit includes the patented Anchor Bolt Locator (ABL) and patent-pending Shallow Anchor Rod (SAR). Uniquely suited for installation to concrete-deck forms, the ABL enables accurate and secure placement of anchor bolts. The structural heavy hex nut is attached to a preformed steel "chair" and becomes the bottom nut of the anchor assembly. The shallow anchor is provided with a plate washer fixed in place that attaches on the ABL nut when assembled and increases the anchor breakout and pullout capacity. The shallow anchor is easily installed before or after placement of the slab reinforcing steel or tendons. Where higher anchor capacities are needed such as at edge conditions or to meet seismic ductility requirements, the anchor kit is combined with anchor reinforcement.

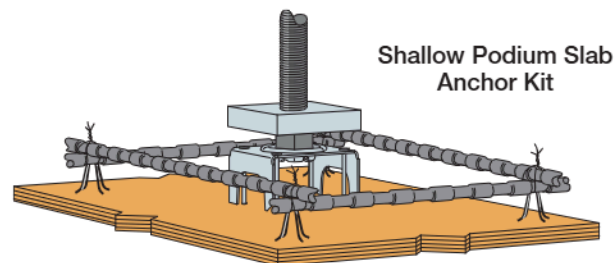

**Shallow Podium Slab
Anchor Kit**

Naming Legend

SA1OST-8H-18KT

- Shallow Anchor
- Standoff (1 for 1" cover)
- Oversize Threads (When hot-dip galvanized anchors are specified)
- High Strength
- Rod Diameter in ⅛" Increments (Ex: 8 = ⅝" or 1")
- Kit (includes ABL and SAR)
- Length (18", 24", 30", 36")